

STAND-UP CHARACTER: PO

ASSEMBLY INSTRUCTIONS



YOU WILL NEED:

- Metal-edged ruler
- Butter knife
- Scissors or craft knife
- Cutting mat (optional)
- Multipurpose glue

GETTING STARTED

- 1** Score all the pieces: Using a ruler as a guide, run the back side of a butter knife firmly along all dashed and dotted lines.



- 2** Using scissors or a craft knife and cutting mat, cut out all pieces along solid lines.



- 3** Fold all pieces along score lines, using the folding key below as a reference.



ASSEMBLY

- 4** Glue tabs on right and left legs to body as shown:

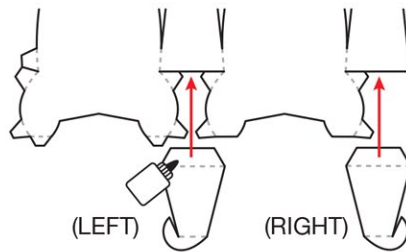

- 5** Glue tabs on front and back of body to sides of body and legs until only the two flaps at top remain open.

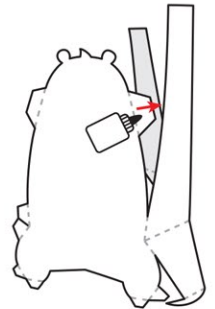

- 6** Glue flaps at top of head together where indicated by artwork.

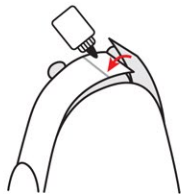

- 7** Glue each foot flap to bottom leg tabs.



- 8** Assemble arms by gluing tabs in place and attaching shoulders to body where indicated by artwork.

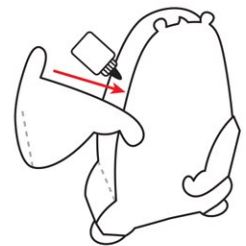

- 9** You're done!



STAND-UP CHARACTER:
PO

